

RFID Reader RF-220

Rapid body camera
allocation device



Connect an RFID reader RF-220 to a DockController DC-200 or EdgeController EC-220 to make body camera allocation quicker and easier, using your organisation's existing ID or access cards.

GENERAL INFORMATION

Marketing name	RF-220
Typical usage	Attached to a DC-200 or EC-220 via USB connection
Management software	VideoManager 9.1 onwards (for High & Low frequency card support)
Warranty	1 year return to Motorola Solutions warranty
Includes snap-in holder	The Snap-in Holder is used to fix the RF-220 to a flat surface
Manufacturing information	Made For Motorola Solutions by ELATEC GmbH, Zeppelinstr. 1, 82178 Puchheim, Germany Model name: Elatec TWN4 MultiTech2 LF HF*

SIZE AND WEIGHT

Dimensions	88 mm x 56 mm x 18 mm
Weight	115 g

TECHNICAL SPECIFICATIONS

Frequency	Low Frequency: 134.2 kHz
	High Frequency: 13.56 MHz
Read/write distance	Low Frequency and High Frequency: 100 mm (4 in)
Supported compatible card standards	Including but not limited to: ISO1443A (e.g. MIFARE Classic) ISO14443B (e.g. HID iCLASS) ISO15693 (e.g. HID iCLASS SE) This includes Avigilon Control Manager door access cards
Operating temperature	0° to 40°C (32° to 104°F)
Storage temperature	-55° to 70°C (-67° to 158°F)

*Customised configuration for Motorola Solutions

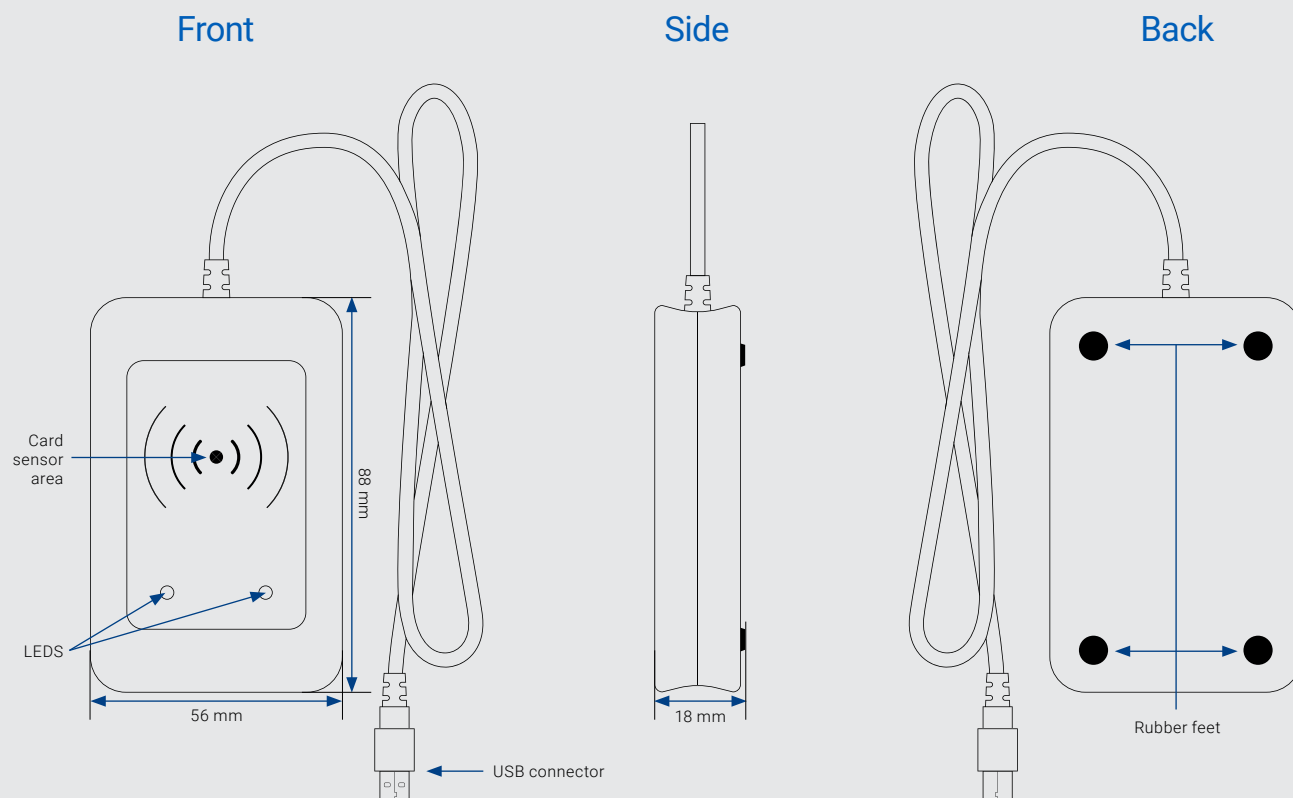

To learn more, visit: www.motorolasolutions.com/BWC



Motorola Solutions Ltd., Nova South, 160 Victoria Street, London, SW1E 5LB, United Kingdom

Available in APAC, EMEA, LATAM and NA.

MOTOROLA, MOTO, MOTOROLA SOLUTIONS and the Stylized M Logo are trademarks or registered trademarks of Motorola Trademark Holdings, LLC and are used under license. All other trademarks are the property of their respective owners. ©2025 Motorola Solutions, Inc. All rights reserved. 02-2025 [EV05]